

Dimensiuni flansa SR EN 1092-1+A1:2013 cu gat sudabil

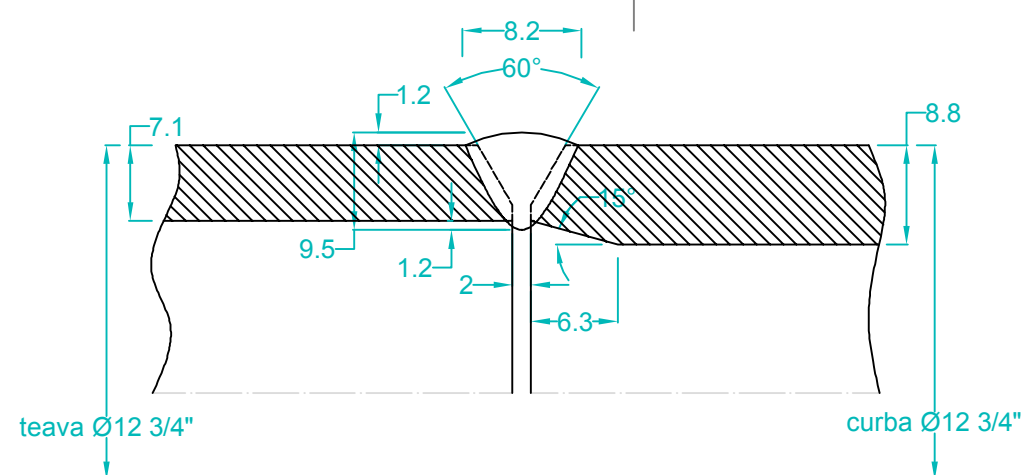
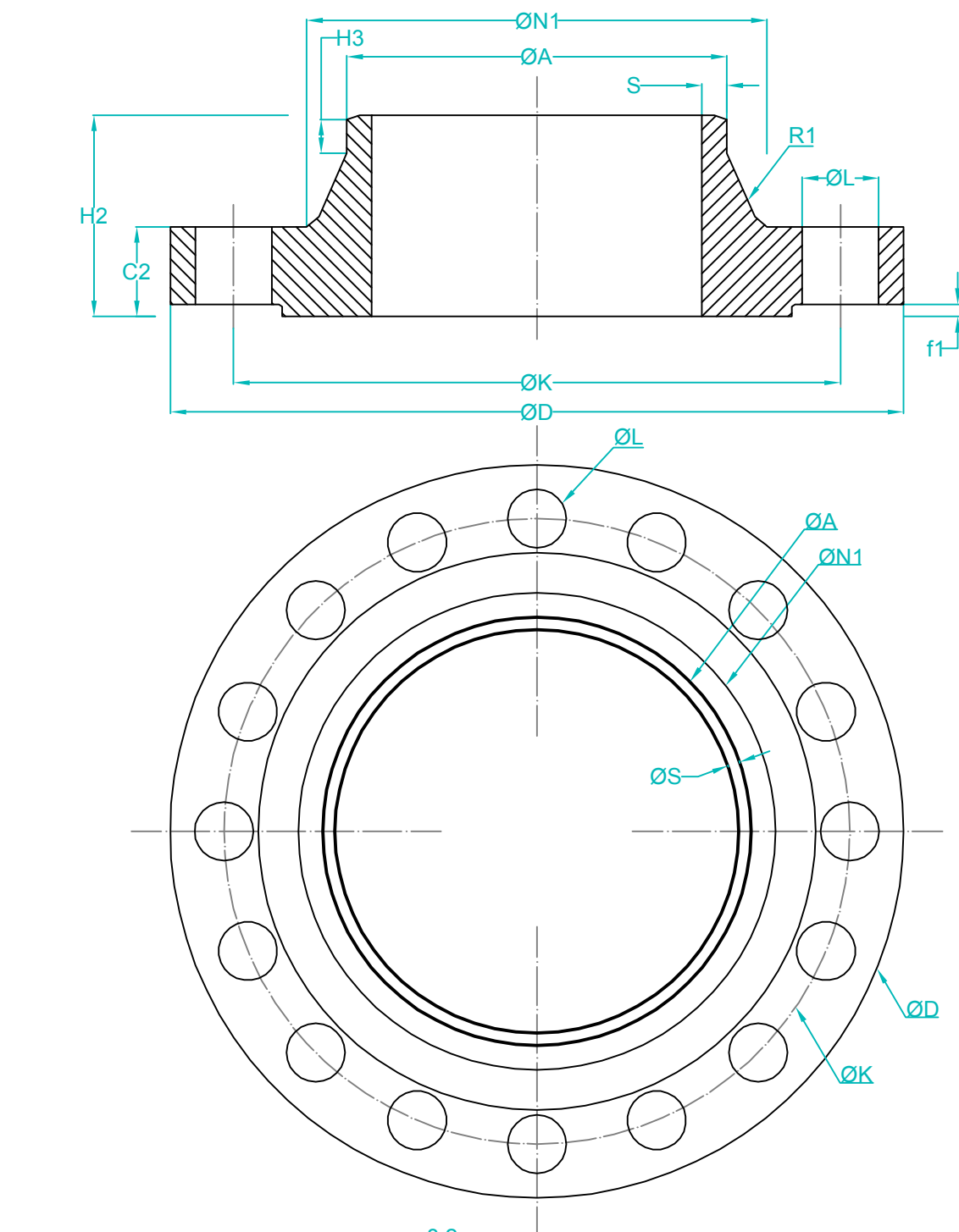

Sudura conducta
Ø12 3/4" - curba Ø12 3/4"

DETALII SUDURI

Sudura conducta Ø12 3/4" - conducta Ø12 3/4"

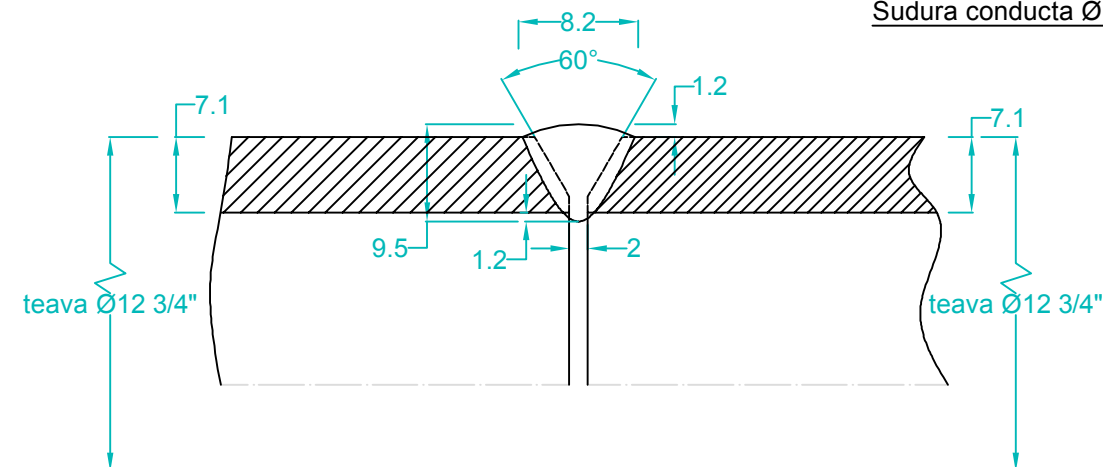

Sudura conducta Ø12 3/4" - flansa cu gat Dn 300

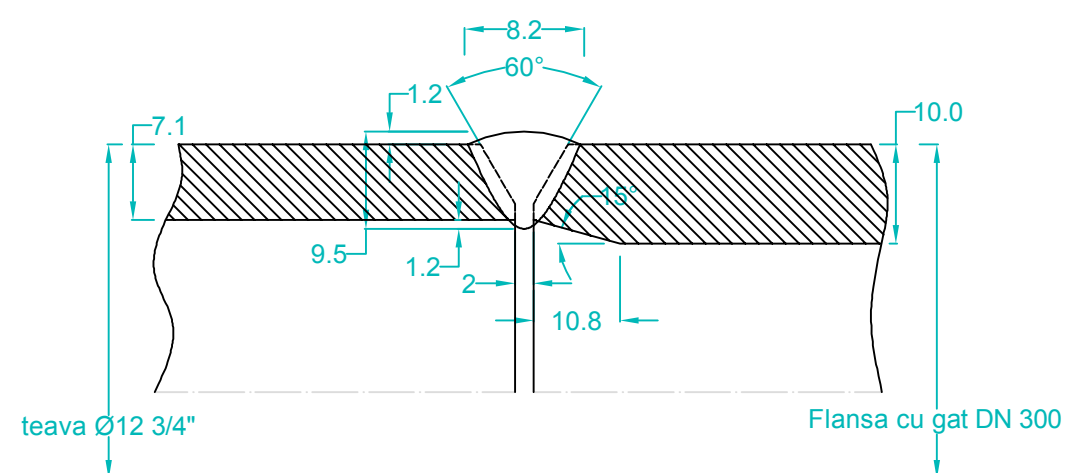

Flansa cu gat DN 300

Dimensiuni montare

DN	Diametre			Suruburi		Diametru exterior gat sudabil	Grosime	Suprafata	Masura		Diametru gat de baza	Raza	Grosim ea gatului	Masa net
mm	Exterior (mm)	Cerc surub	Gaura surub	Nr.	Tip	mm	mm	mm	H2	H3	N1	R1	S	Kg
300	530	460	36	16	M33	323,9	52	2	140	18	372	12	10.0	67.50

Verificator/
Expert

Nume

Semnatura

Cerinta

Referat / Expertiza Nr. / Data

S.C. SNIF PROIECT S.A. Targoviste
Numar de inmatriculare J15/925/2005

Beneficiar:
CONPET S.A. PLOIESTI

Pr. nr.
309

Specificatie

Nume

Semnatura

Scara:

Inlocuire conducta de transport titer Ø12" si Ø14" Cartojani-Ploiesti in zonele: Crivat-Catunu pe o lungime de cca. 550m+30m foraj orizontal subtraversare DN 1A Bucuresti-Ploiesti, loc. Ghimpati - traversare rau Colentina pe o lungime de cca. 500m si loc. Sfântu Gheorghe - Crevedia Mica, pe o lungime de cca. 1.100m, cu un total de 2.180m pe fir

Faza
PT+CS+D

Desenat

Ing. Radu Florin

Data:

2015

- Detalii suduri
- Dimensiuni flansa cu gat sudabil Dn 300

Pl. nr.
16